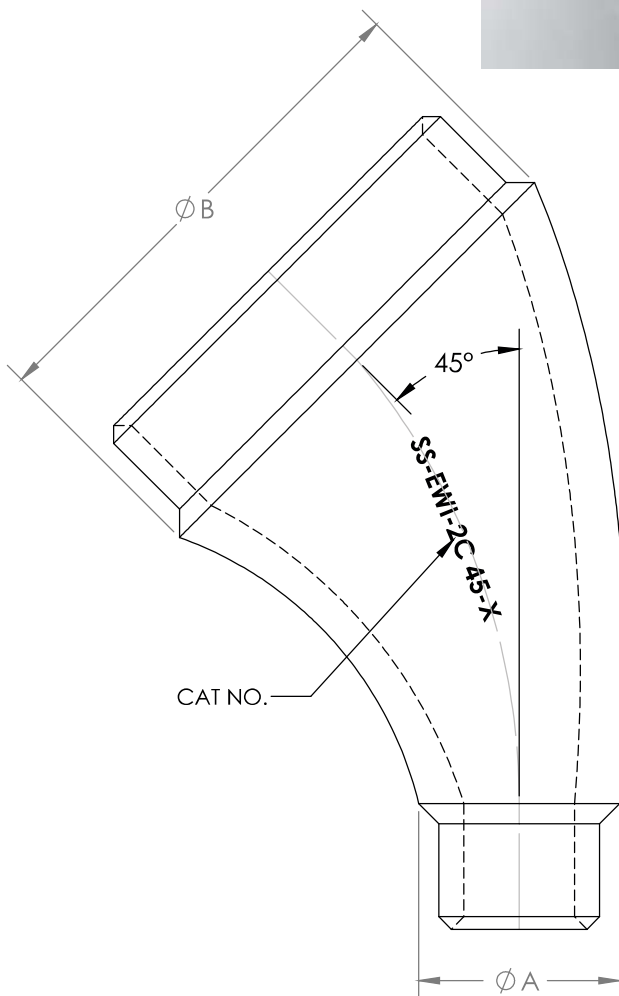

# TBWI-2C-45

**NOTES:**

- To connect a two busbars.
- Material: Cast aluminium.
- Cat No. to be stamped in location shown.
- Welded areas to be cleaned with a stainless steel wire brush before welding.
- Supplied in a clear, sealed, heavy duty, UV stabilized plastic bag.

ESKOM CODE	PLP CATALOGUE NO.	TUBE DIAM. (A) mm	TUBE DIAM. (B) mm	MINIMUM RATED CURRENT @ 90°C	MAXIMUM VOLTAGE kV rms	WEIGHT kg
EWI-2C 45-A	TBWI-80-200-45	80	200	2000	420	4.3
EWI-2C 45-B	TBWI-80-250-45	80	250	2000	420	6.1
EWI-2C 45-C	TBWI-120-200-45	120	200	3150	800	5.7