

TBTC-C3

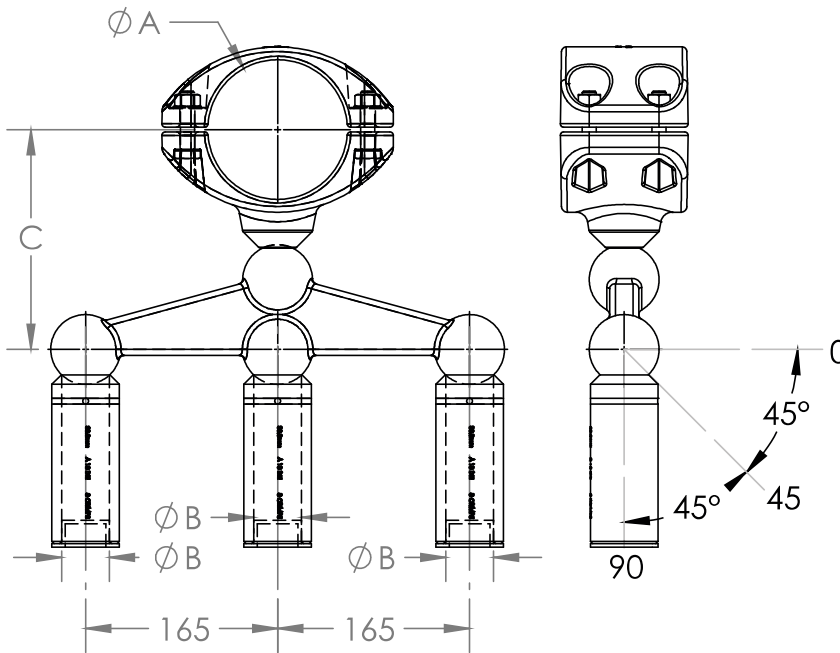
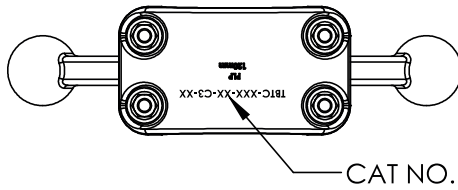

NOTES:

- To connect a busbar to triple stranded conductor.
- Material: Fasteners for:
Tube Diam. 150-250mm.
Anodised HT 7075 AL Alloy
Extruded aluminium tubing
Components are cast aluminium.
- Bolt torque values:
M10 (St steel) 35Nm, (AL.) 21Nm
M12 (St steel) 60Nm, (AL.) 36Nm
- Cat No. to be stamped in location shown.
- All bolted joint clamp and conductor/busbar surfaces to be cleaned with a stainless steel wire brush and a suitable conductive grease applied before use.
- Supplied in a clear, sealed, heavy duty, UV stabilized plastic bag.

ESKOM CODE	PLP CATALOGUE NO.	TUBE		(C)	ANGLE OFFSET	AFTER COMP. (A.F.) mm	ALCAN DIE	MINIMUM RATED		WEIGHT kg
		DIAM. (A) mm	CONDUCTOR DIAM. (B) mm					CURRENT @ 90°C	VOLTAGE kV rms	
ETP-IL-3-G	TBTC-200-38-C3-0	200	3X38.3	220	0	49	DA-13	4000	420	15.2
ETP-IL-3-H	TBTC-200-38-C3-45	200	3X38.3	220	45	49	DA-13	4000	420	15.2
ETP-IL-3-J	TBTC-200-38-C3-90	200	3X38.3	220	90	49	DA-13	4000	420	15.2
ETP-IL-3-K	TBTC-250-38-C3-0	250	3X38.3	245	0	49	DA-13	4000	420	17.1
ETP-IL-3-L	TBTC-250-38-C3-45	250	3X38.3	245	45	49	DA-13	4000	420	17.1
ETP-IL-3-M	TBTC-250-38-C3-90	250	3X38.3	245	90	49	DA-13	4000	420	17.1