

## TBEC-C

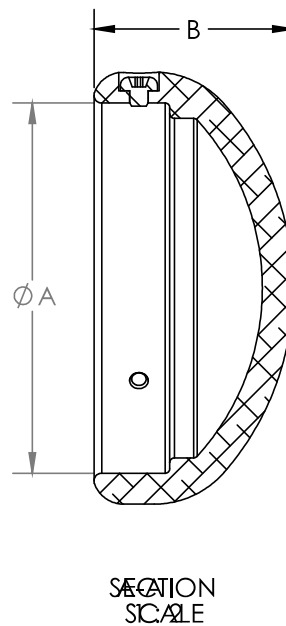
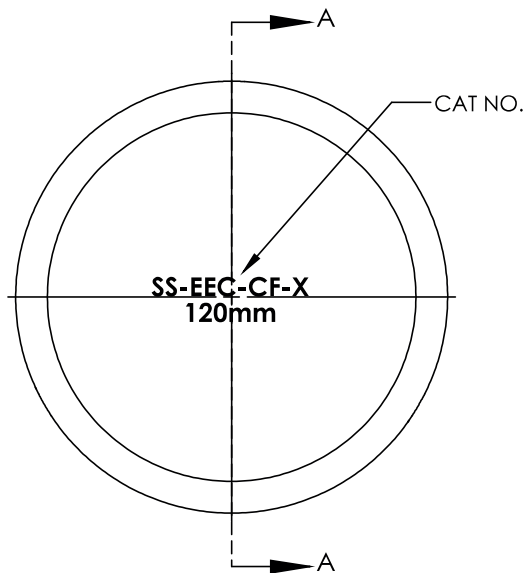

**NOTES:**

- Busbar encap 80-250mm (corona-free)
- Material: Fasteners for:  
Cast aluminium  
Stainless steel fasteners.
- Bolt torque values:  
M6 (St steel) 20Nm  
M8 (St steel) 25Nm
- Cat No. to be stamped in location shown.
- All bolted joint clamp and conductor/busbar surfaces to be cleaned with a stainless steel wire brush and a suitable conductive grease applied before use.
- Supplied in a clear, sealed, heavy duty, UV stabilized plastic bag.
- Castings can be powder coated to either White/Blue/Red. Add suffix "-W"/"-B"/"-R"/ to tabulated PLP Catalogue number. E.G. TBEC-C-120-B

ESKOM CODE	PLP CATALOGUE NO.	TUBE DIAM. (A) mm	(B) mm	MAXIMUM VOLTAGE kV rms	WEIGHT kg
EEC-CF-A	TBEC-C-80	80	60	145	0.43
EEC-CF-C	TBEC-C-120	120	65	145	0.75
EEC-CF-F	TBEC-C-200	200	86	800	2.62
EEC-CF-G	TBEC-C-250	250	100	800	5.04