

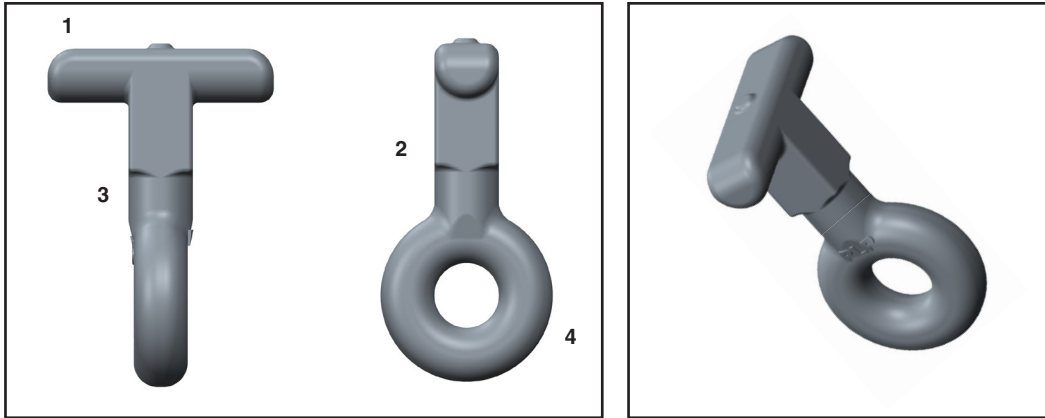

# BRACE-EYE™

Be sure to read and completely understand this procedure before applying product. Be sure to select the proper PREFORMED™ product before application.



**NOMENCLATURE**

- 1. "T" Section
- 2. Square Neck
- 3. Round Neck
- 4. Eye

BRACE-EYE Catalog No.	Strand Size	Recommended Minimum Slot Sizes		Recommended Maximum Slot Size	
		Width (mm)	Length (mm)	Width (mm)	Length (mm)
60110	1/4" (6.4)	13/16" (20.6)	2" (50.8)	15/16" (23.8)	Optional
	5/16" (7.9)				
	3/8" (9.5)				
60112	7/16" (11.1)	1-1/4" (31.8)	2" (50.8)	1-7/16" (36.6)	
	1/2" (12.7)				

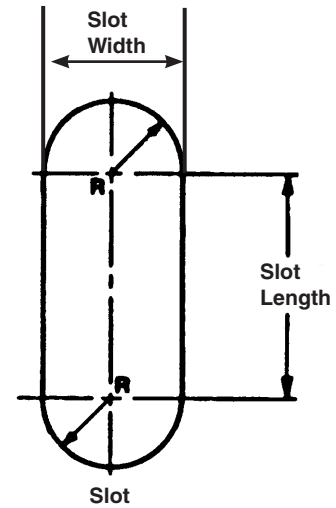

BRACE-EYE not available for strand sizes 9/16" and larger.

**Step 1 SELECTING THE PROPER BRACE-EYE**

The chart shows the recommended BRACE-GRIP Dead-ends, strand sizes and slot dimensions to use with the BRACE-EYE.

## Step 2 FIELD APPLICATION OF BRACE-GRIP® DEAD-END WITH BRACE-EYE

Insert "T" Section on an angle through the slot until round neck rests on web plate. Then, turn the BRACE-EYE 90 degrees.



**Step 3** Pull the BRACE-EYE toward you until the "T" Section rests against the back of the web plate. The square neck locks the BRACE-EYE in place.



Completed application above.

**Step 4** Be sure to obtain the proper tension for the strand by tightening the nut on the eyebolt at the opposite end of the assembly. **In a high loading area or if reinforcement is desired, include a backup plate or washer.**

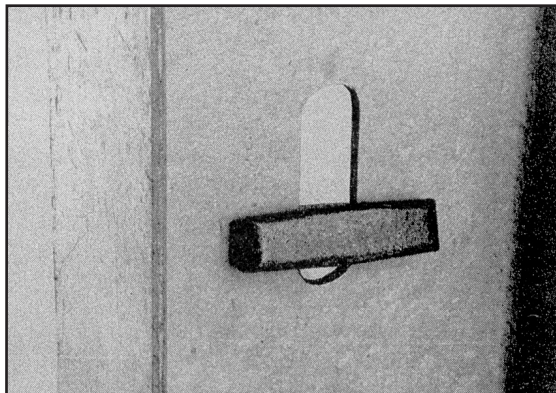

## SAFETY CONSIDERATIONS

This application procedure is not intended to supersede any company construction or safety standards. This procedure is offered only to illustrate safe application for the individual. **FAILURE TO FOLLOW THESE PROCEDURES MAY RESULT IN PERSONAL INJURY OR DEATH.**

This product may be removed and reinstalled if it is in good condition. After extended service life, it is recommended the product not be reused once removed from service.

**Do not modify this product under any circumstances, unless specifically stated in this procedure.**

This product is intended for use by trained technicians only. **This product should not be used by anyone who is not familiar with, and not trained to use it.**

When working in the area of energized lines, extra care should be taken to prevent accidental electrical contact.

For proper performance and personal safety, be sure to select the proper size PREFORMED™ product before application.

PREFORMED products are precision devices. To insure proper performance, they should be stored in cartons under cover and handled carefully.



# PREFORMED LINE PRODUCTS

P.O. Box 91129, Cleveland, Ohio 44101 • 440.461.5200 • www.preformed.com • e-mail: inquiries@preformed.com

SP3220-1