

Y-Clevis Eye – 30K

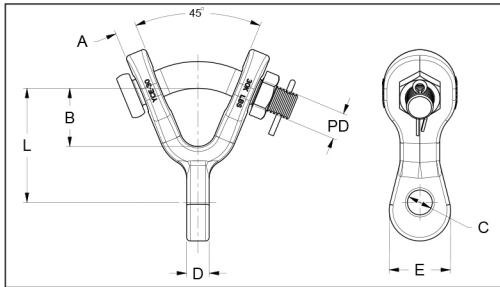
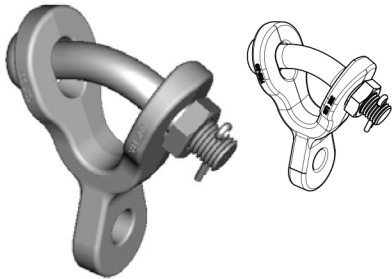

Features	
Body	Ductile iron, hot dip galvanized
Hardware	Galvanized Steel
Cotter Pin	Stainless Steel

Catalog Number	General Dimensions – inches (mm)							Vertical Ultimate Strength lbf (kN)	Wt. Per 100 Units lbs (kg)
	A	B	C	D	E	L	PD		
YCE-30	19/32 (15)	1-3/4 (44.5)	11/16 (17.5)	5/8 (15.9)	1-11/16 (42.8)	3-5/32 (80.2)	3/4 (19)	30,000 (133)	190 (86)