

Transmission Line String Hardware

Anchor Shackle

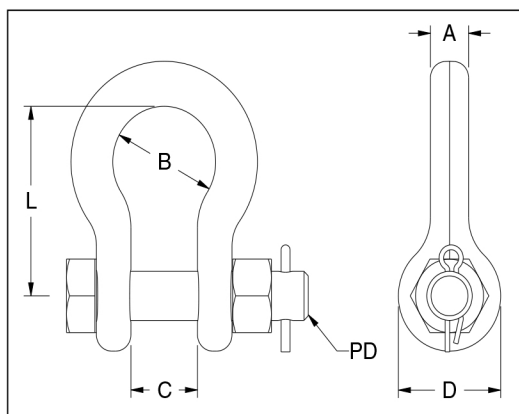
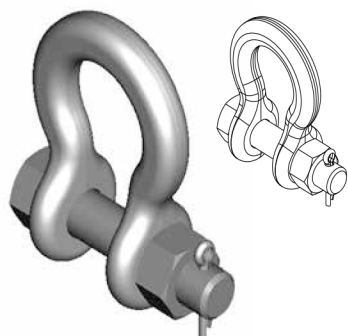

Features	
Body	Forged steel, hot dip galvanized
Hardware	Galvanized Steel
Cotter Pin	Stainless Steel

Catalog Number	General Dimensions – inches (mm)						Vertical Ultimate Strength lbf (kN)	Wt. Per 100 Units lbs (kg)
	A	B	C	D	L	PD		
AS-30-BNK	17/32 (13.5)	1-1/4 (31.8)	15/16 (23.4)	1-1/4 (31.8)	2-3/4 (70)	5/8 (16)	30,000 (133)	108 (49)
AS-50-BNK	5/8 (16)	1-11/16 (43)	1-1/8 (28)	1-11/16 (43)	2-29/32 (74)	3/4 (19)	50,000 (222)	170 (77)
AS-70-BNK	3/4 (19.1)	2 (51)	1-15/16 (33)	2 (51)	3-19/32 (91)	7/8 (22)	70,000 (311)	235 (106)
AS-100-BNK	1-1/8 (28.4)	2-1/4 (57)	1-21/32 (41.6)	2-1/4 (57)	3-19/32 (91)	1-1/8 (28)	100,000 (445)	525 (238)