



BIRD PERCH DETERRENT™ FOR STRUCTURAL STEEL

Be sure to read and completely understand this procedure before applying product.
Be sure to select the proper size PREFORMED™ product before application.



Step #1 Spread the vertical uprights of the Bird Perch Deterrent and ensure that the helical upright is on the vertical side of the structure angle iron.

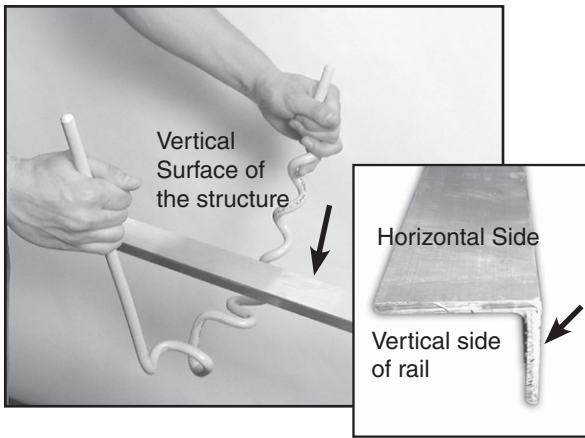

Step #3 Rotate the Bird Perch Deterrent 90° clockwise in the horizontal plane and position the diverter where desired.

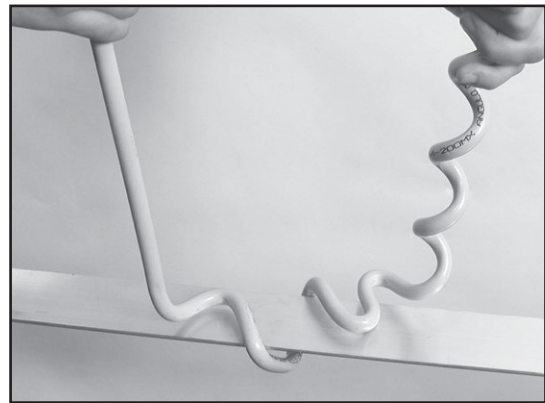

Step #2 Keeping the uprights of the Bird Perch Deterrent apart, position the unit so that the flat sides of the deterrent are on top of the horizontal surface.

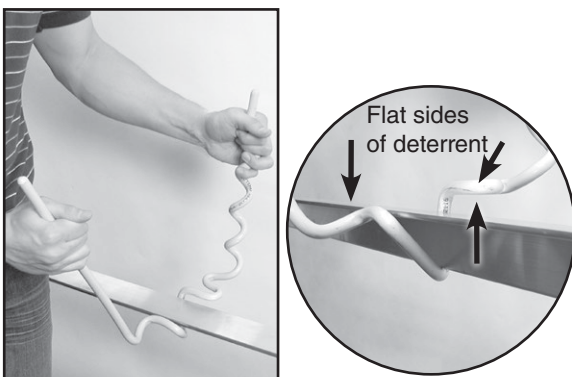

Step #4 Approximately 12" (304 mm) away from the first deterrent, repeat steps 1-3 for the second deterrent.

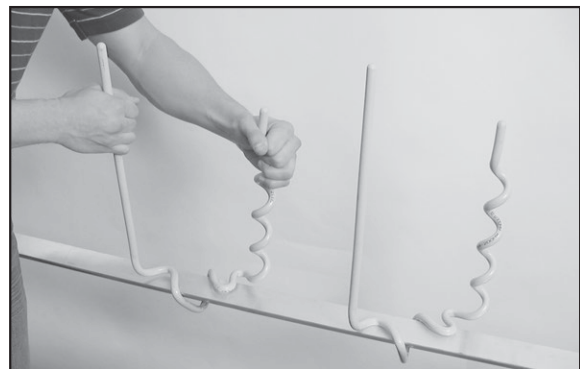

Step #5 Slide the second deterrent to position it next to the first, placing the helical upright behind the straight upright of the first unit.



Step #7 Continue wrapping the helical leg until it is completely installed.

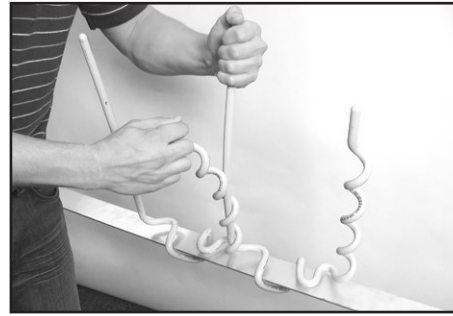

Step #6 Wrap the helical upright of the second deterrent around the straight upright of the first deterrent. Ensure that the bottom helical wrap is installed properly.

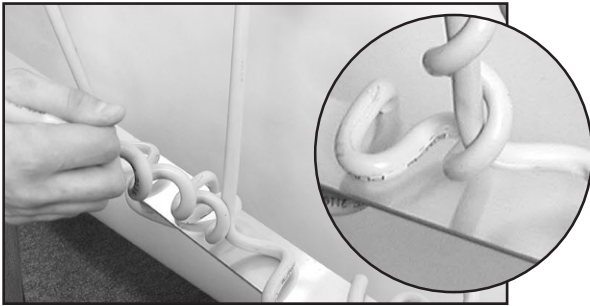

Step #8 Repeat the above steps until the desired coverage is achieved. Two Bird Perch Deterrents

cover approximately 16" (406 mm) and approximately 14" (355 mm) high.

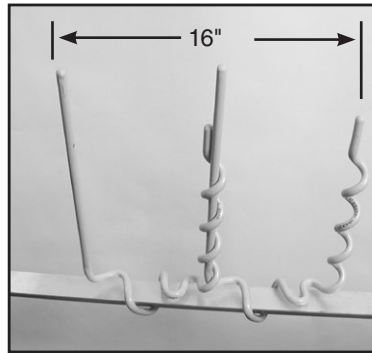

SAFETY CONSIDERATIONS

This application procedure is not intended to supersede any company construction or safety standards. This procedure is offered only to illustrate safe application for the individual. **FAILURE TO FOLLOW THESE PROCEDURES MAY RESULT IN PERSONAL INJURY OR DEATH.**

This product may be removed and reinstalled during the initial installation if it is in good condition. After extended service life, it is recommended the product not be reused once removed from service.

Do not modify this product under any circumstances.

This product is intended for use by trained technicians only. **This product should not be used by anyone who is not familiar with, and not trained to use it.**

When working in the area of energized lines, extra care should be taken to prevent accidental electrical contact.

For proper performance and personal safety, be sure to select the proper size PREFORMED product before application.

PREFORMED products are precision devices. To insure proper performance, they should be stored in cartons under cover and handled carefully.



PREFORMED LINE PRODUCTS

P.O. Box 91129, Cleveland, Ohio 44101 • 440.461.5200 • www.preformed.com • e-mail: inquiries@preformed.com
©2013 Preformed Line Products. All rights reserved.

SP3143