



RAPTOR PROTECTOR™ Dead-end Cover

Patented

IMPORTANT:

The RAPTOR PROTECTOR is intended to permanently cover-up energized conductors at support points solely for the purpose of preventing accidental contact between the conductors and birds. IT IS NOT A COMPLETELY INSULATED COVERING AND SHOULD NOT BE USED TO PROTECT HUMANS FROM ELECTRICAL SHOCK. Be sure to read and completely understand this procedure before applying product. Be sure to select the proper PREFORMED product before application.



NOMENCLATURE

- 1. RAPTOR PROTECTOR Dead-end (Black) (1)
- 2. Pigtail
- 3. Hold down block

TOOL RECOMMENDATIONS

- 1. Saw or other tool for cutting
- 2. Shotgun hot stick (optional)
- 3. Applicator ring tool (optional)

The RAPTOR PROTECTOR is designed for use on dead-end insulator supports.

Pre-Installation



For assistance with the pre-installation portion of this application, watch the video entitled "RAPTOR PROTECTOR™ Dead-end Pigtail Installation" that can be found by scanning this QR code or visiting www.youtube.com/preformedco.

Step #1

Hold the pigtail so that the hook nose is pointing upwards and in line with the cover.

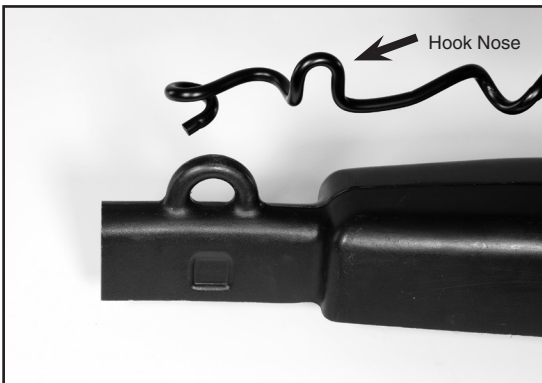

Step #2

Press the end of the pigtail through the Raptor Protector Cover's eye hook. Hook and rotate 180°. The pigtail should be in line with the cover.

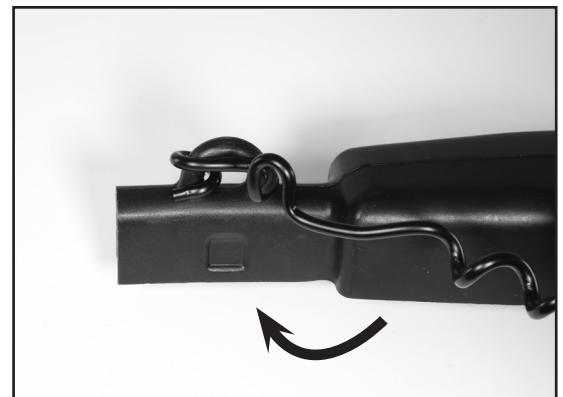

Step #3 Pull the pigtail back until it is perpendicular or slightly beyond perpendicular to the cover.

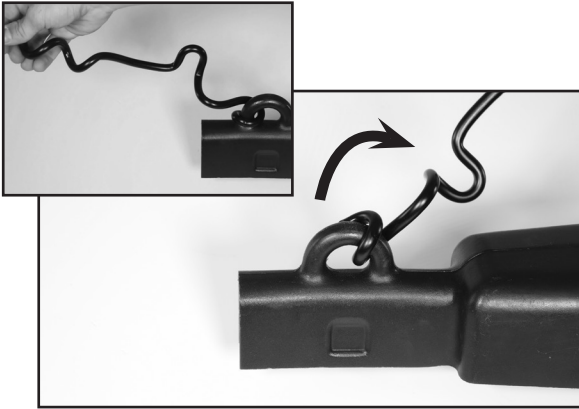

Step #4 Rotate the pigtail out and away from the cover assuring the trimmed end passes through the eye hook of the Dead-end Cover.



Step #5 Pull the pigtail up and in line with the cover.

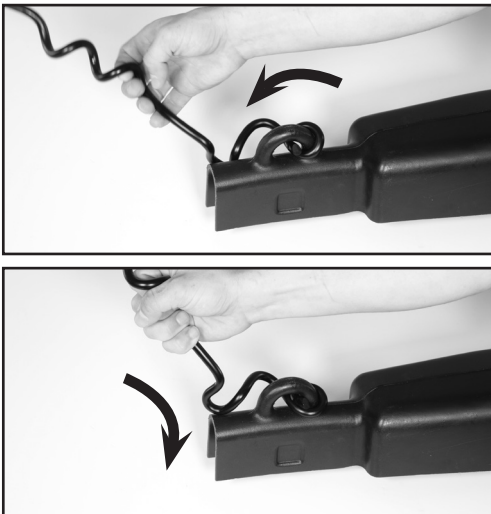

Step #6 Completed pre-installation shown below.

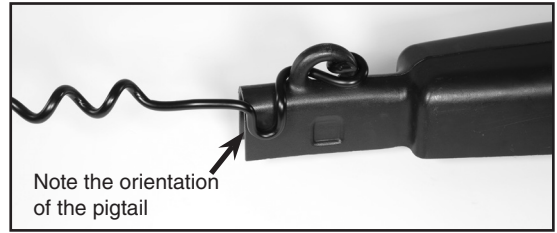

Installation – Jumper

Step #7 Place the RAPTOR PROTECTOR™ over the connection hardware, sliding it up to cover the conductive connection at the insulator. Locate the line on the cover where the jumper would come through the cover. This is the cut point.



Step #8 Use a saw or other tool to cut as shown below until the estimated distance is reached.

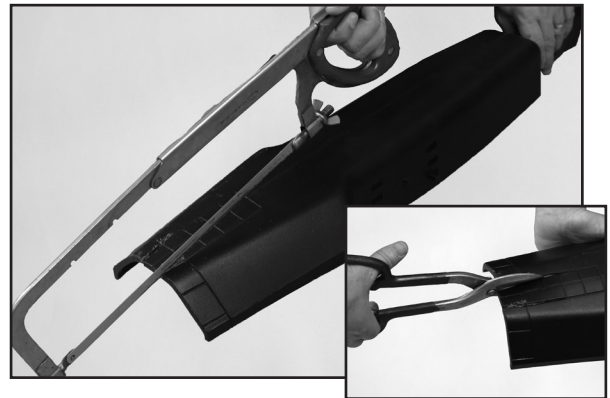

Step #9 Leave the tab attached to the RAPTOR PROTECTOR™. Fold back the tab as shown below for additional coverage.

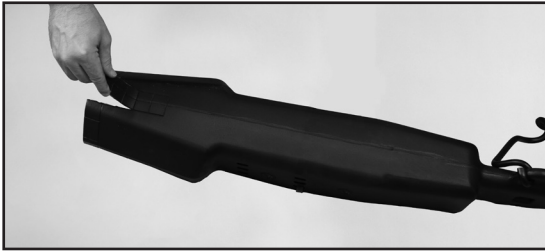

Step #10 Place the RAPTOR PROTECTOR over the conductor as shown below. Make sure it is as close to the dead-end insulator as possible without covering any skirts.



Step #11 Ensure that the RAPTOR PROTECTOR remains in place while wrapping the pigtail on the conductor.



Step #12 Snap in the end of the pigtail.



Step #13 Insert the hold down block under the conductor and place into the appropriate holes on both sides of the RAPTOR PROTECTOR COVER to ensure a tight fit.

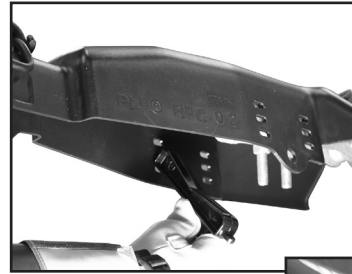

NOTE: Hole position of clip may vary based on conductor and hardware size.

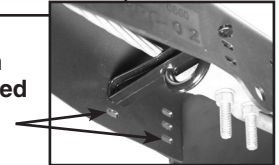

Step #14 Completed RAPTOR PROTECTOR Installation shown below.



Installation – Hot Stick

Step #15 Repeat Steps #1-9.

Using the hot stick loops on the bottom of the cover, grab the RAPTOR PROTECTOR. Place on the conductor as close to the dead-end insulator as possible without covering it.



Step #16 Re-grab the RAPTOR PROTECTOR™ using the hot stick hole at its tail end. Pull down with the hot stick to keep the RAPTOR PROTECTOR secure while wrapping on the pigtail with the applicator ring tool.



Step #18 Completed RAPTOR PROTECTOR. Installation shown below.

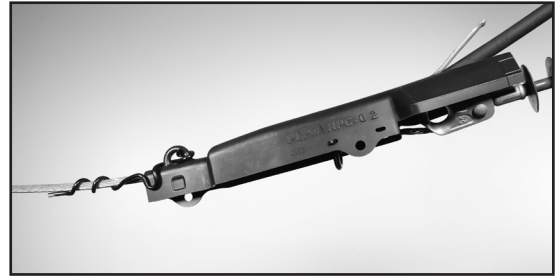

Step #17 Grab the lift prevention clip with the hot stick, rotate it under the conductor, and place into the appropriate hole on the other side of the RAPTOR PROTECTOR to ensure a tight fit between the lift prevention clip and the conductor.



NOTE: Hole position of clip may vary based on conductor and hardware size.

SAFETY CONSIDERATIONS

This application procedure is not intended to supersede any company construction or safety standards. This procedure is offered only to illustrate safe application for the individual. **FAILURE TO FOLLOW THESE PROCEDURES MAY RESULT IN PERSONAL INJURY OR DEATH.**

This product may be removed and reinstalled if it is in good condition. After extended service life, it is recommended the product not be reused once removed from service.

Do not modify this product under any circumstances, unless specifically stated in this procedure.

This product is intended for use by trained technicians only. **This product should not be used by anyone who is not familiar with, and not trained to use it.**

When working in the area of energized lines, extra care should be taken to prevent accidental electrical contact.

For proper performance and personal safety, be sure to select the proper size PREFORMED™ product before application.

PREFORMED products are precision devices. To insure proper performance, they should be stored in cartons under cover and handled carefully.



PREFORMED LINE PRODUCTS

P.O. Box 91129, Cleveland, Ohio 44101 • 440.461.5200 • www.preformed.com • e-mail: inquiries@preformed.com

SP3204-2