



PREFORMED LINE PRODUCTS
The connection you can count on.

Ranger **SERVISEAL**[®]
CLOSURE
Super **SERVISEAL**[®]
CLOSURE



COMMUNICATIONS



ENERGY



SPECIAL INDUSTRIES



SOLAR





Cap, Bond Connector and Splices



Vial and Cap



Cap Thread Locking Feature



PREFORMED
LINE PRODUCTS

World Headquarters
660 Beta Drive
Cleveland, Ohio 44143

Mailing Address:
P.O. Box 91129
Cleveland, Ohio 44101

Telephone: 440.461.5200
Fax: 440.442.8816
Web Site: www.preformed.com
E-mail: inquiries@preformed.com

© 2009 Preformed Line Products
Printed in U.S.A.
CO-SS-1049
05.09.2M

PLP Copper Products

Ranger SERWISEAL® and Super SERWISEAL® CLOSURE

Description

The vial of the Ranger SERWISEAL® Closure (up to 6-pair) and the Super SERWISEAL® Closure (up to 12-pair) comes pre-filled with POLY-BEE™ Sealant, which forms a field proven (over 14 years) protective barrier around the individual splice connectors.

Two-piece design

There are no loose parts. Each SERWISEAL Closure consists of a pre-filled vial, and a cap assembly with integral insertion ram and bonding connector.

Fast, easy installation

After preparing the service wires, simply lay them within the grooves in the cap, lay the exposed cable shield within the bond connector and tighten. Splices on the individual pairs are easily organized around the integral insertion ram.

Size	A (mm)	B (mm)	C (mm)	D (mm)
Ranger	5-1/2" (140)	2-3/8" (60)	1-5/8" (41)	1-5/8" (41)
Super	6-1/2" (165)	3-1/4" (83)	2-3/16" (56)	1-7/8" (43)

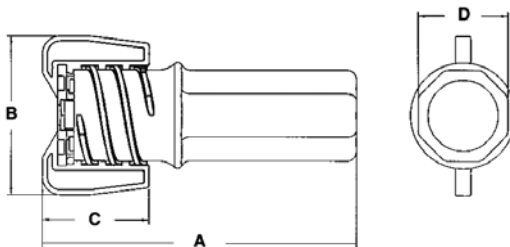

Features

- Only two components; filled vial and cap with integral ram & bond connector.
- Octagon shaped vial for ease of application and maximum capacity.
- Pre-filled with POLY-BEE Sealant; field proven for over 14 years.
- Improved integral bonding connector
- Positive locking feature to insure proper application and to discourage reuse.
- RUS Llisted

A twist & snap secures everything

The SERWISEAL Closures now have a locking feature on the threads of the vial which provides a clear indication that it is fully engaged and prevents reuse of the vial.

Compact size

The table below shows the overall dimensions of the SERWISEAL Closures

Ordering Information

Catalog Number	Description
8006137	Ranger SERWISEAL Closure for up to 6 pair (0.5 diameter) Service Wire
8006039	Super SERWISEAL Closure for up to 12 pair (0.6 diameter) Service Wire
80008946	Replacement Vial (filled) for Ranger SERWISEAL Closure
80851909	Replacement Vial (filled) for Super SERWISEAL Closure